



Important

- Please inspect this product immediately on delivery to ensure that it has not been damaged in transit and is complete. Any claim for damage or shortage will not be entertained unless received within 3 days.
- To ensure this product is installed properly, you must read and follow these guidelines.
- Please read the whole of these instructions before starting installation.
- Be sure your installation conforms to local regulations.
- We recommend that this product is installed by a qualified professional contractor.
- Please refer to the specification and assembly drawings attached.
- Before installation, please inspect this product to ensure that it is the correct model and you have all the parts required for proper installation.
- Take all the necessary precautions to ensure that all parts are properly protected during installation. Polished and plated surfaces are particularly prone to damage from dirty and incorrect tools; spanners should be suitably lined so as not to damage plated or polished nuts.

Flush the existing system with water to ensure that there is no debris in the existing pipework before commencing installation.

When drilling holes in walls or floors be aware of any existing pipes or cables.

Drummonds can supply various soil pipe extensions to help with the variations in your installation.

Before starting the installation determine the position of the pan, seat and cistern position. The 15mm supply pipe should be made up ready before installation. Note that once installed the toilet seat and lid should be capable of remaining in the upright position resting upon the cistern

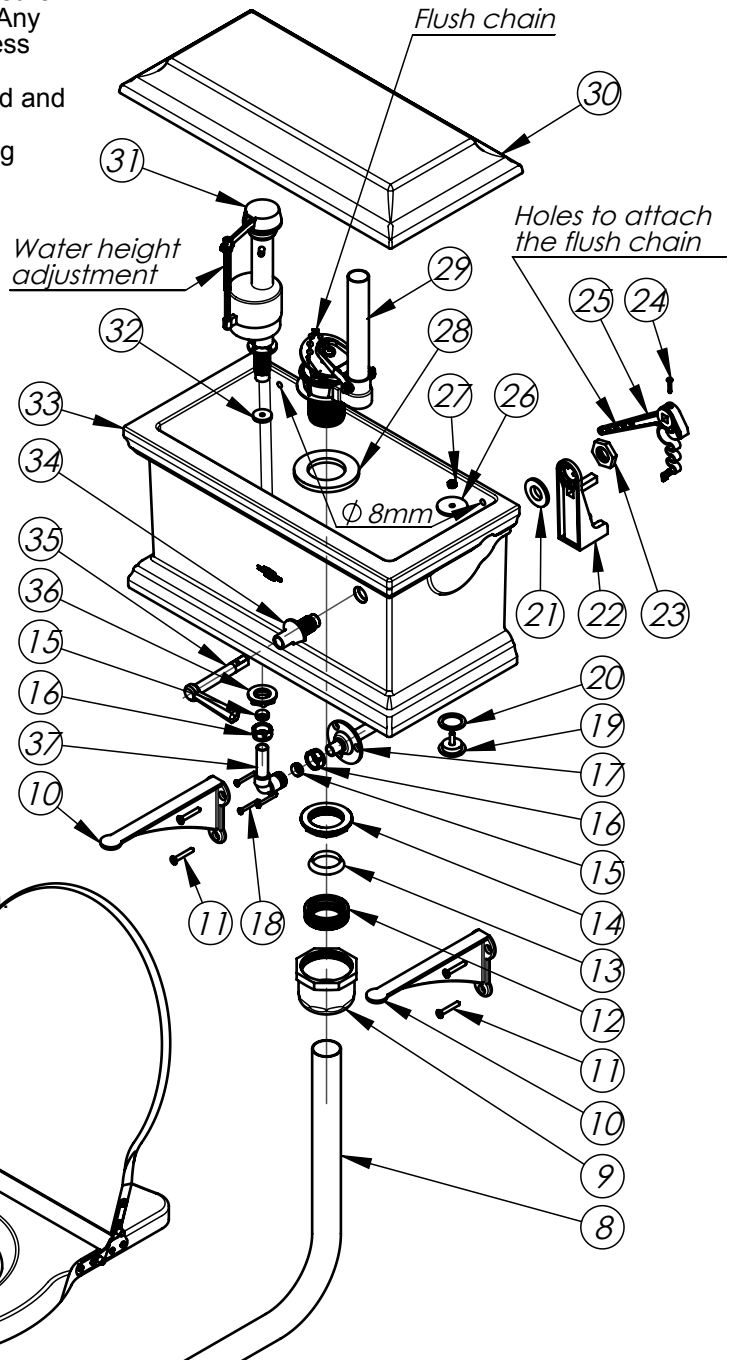

ITEM NO.	NAME	NO OF.
1	The Dunnett WC Pan	1
2	12x2.1/2" screws	4
3	Nut M6	2
4	Washer Ø6	2
5	Rubber washer	4
6	Standard seat	1
7	Flush Pipe Cone	1
8	Low level flush pipe	1
9	Flush pipe nut cover	1
10	Cistern brackets	1pr
11	12x1.1/2" screws	6
12	Compression nut	1
13	Olive	1
14	Flush valve back nut	1
15	Olive Ø 15	2
16	1/2" Nut	2
17	Escutcheon	1
18	8x1.1/2" screws	3
19	Cover plug	1
20	Washer	1
21	Plastic washer	1
22	Lever return spring base	1
23	Bush backnut	1
24	Grub screw	1
25	Flush arm	1
26	Cover plug retaining plate	1

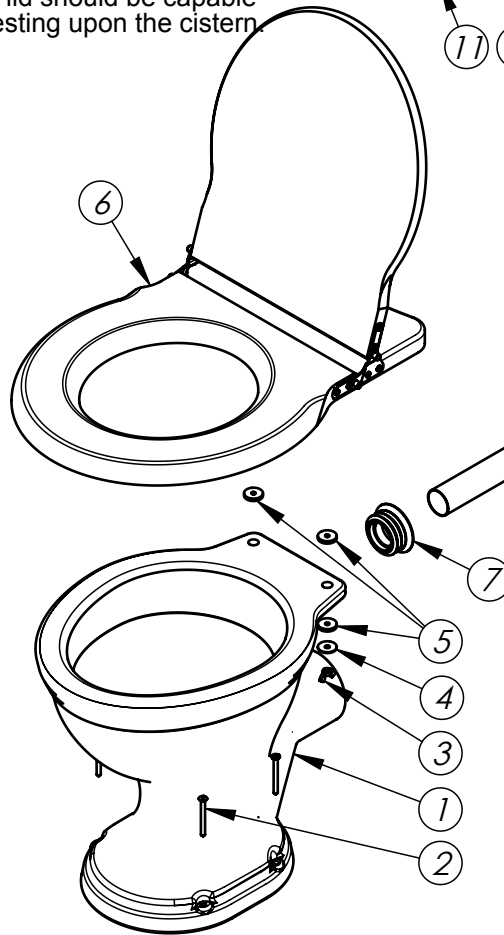

27	Nut M6	1
28	Washer	1
29	Flush Valve	1
30	Lid	1
31	Float valve	1
32	Washer	1
33	Low level cistern	1
34	Lever bush	1
35	Flush lever	1
36	1/2" bsp backnut	1
37	Cistern pipework set	1

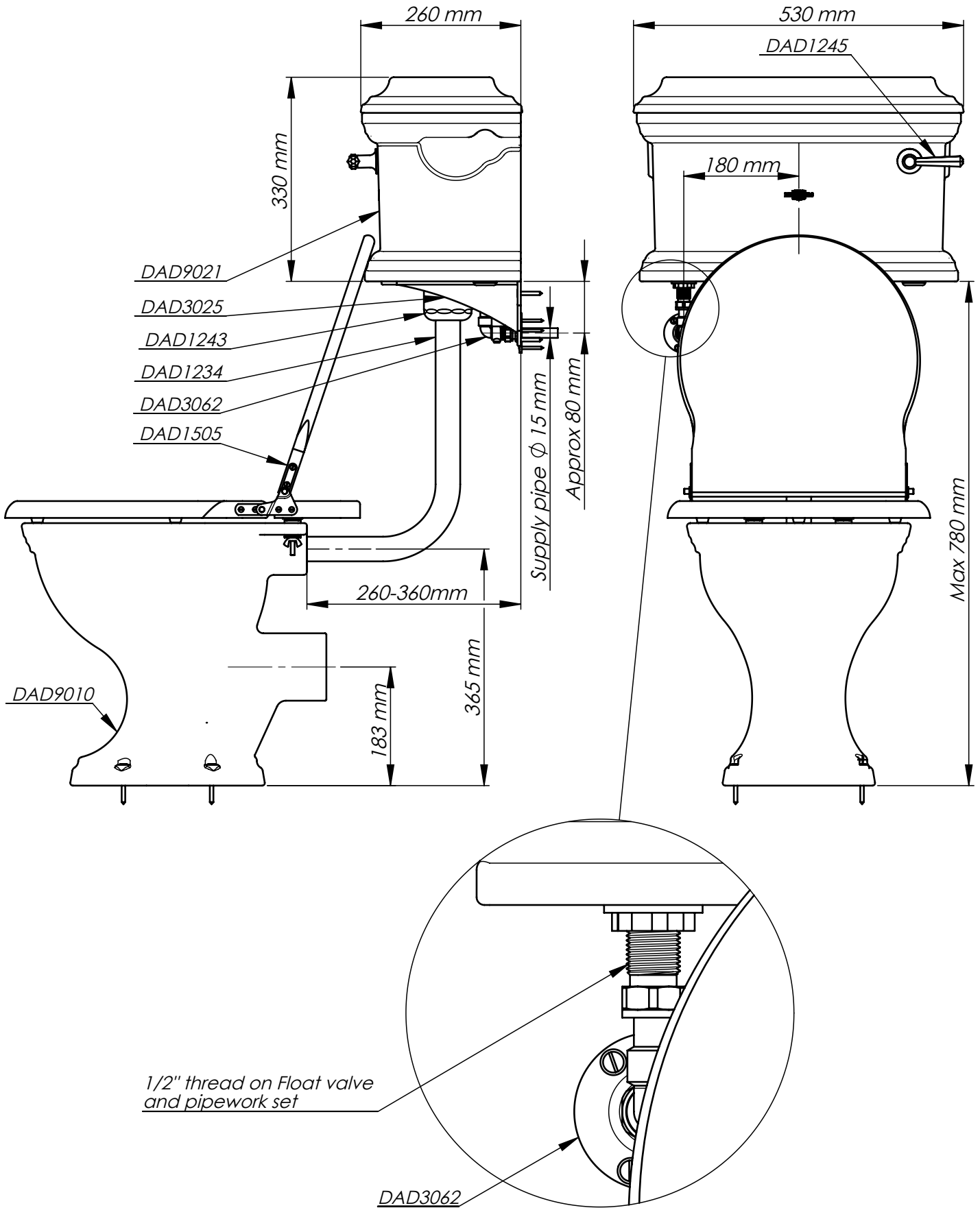



1. Fit the pan (1) DAD9010 so that the inlet spigot distance from the wall is approximately 355mm, screw to the floor using the screws provided - do not over tighten as this could cause damage to the pan - then connect up the outlet. Note once installed the toilet seat lid should be capable of remaining in the upright position against the cistern.
2. Trim the overflow on the flush valve (29) to the correct height if necessary then install the flush valve (29) and washer (28) with a suitable sealant into the cistern base ensuring correct orientation. From under the cistern secure in place with flush valve back nut (14) and sealant using enough force to create a seal.
3. Fix the two brackets (10) to the wall (take care of any plated surfaces) at a suitable height and distance apart (take note of the supply pipe location) making sure that they are level and vertical and in line relatively with the pan.
4. Before the cistern is fixed in place the flush pipe needs to be fitted but it is advised to pre drill and plug the cistern-to-wall fixing holes first, make sure that once fitted the flush pipe will be vertical and central to the pan and cistern. The flush pipe can be cut in height and depth to fit if necessary. The ideal position as shown in the diagrams is for the seat to rest when open onto the cistern.
5. Place the cistern (33) upon the brackets. Trim the flush pipe (8) to the correct length then after protecting the pipe with tape from scratches slide onto the cistern end of the flush pipe the flush pipe nut cover (9), compression nut (12) and olive (13). Seal the lower section into the pan with the cone (7) using suitable sealant and insert the top of the flush tube into the base of the flush valve ensuring that both ends are pushed fully home.
6. Fix the cistern to the wall through the 8mm holes at the back of the cistern, do not over tighten as this could damage the cistern, use rubber washers if necessary.
7. Slide up the olive (13) and secure with compression nut (12) using only sufficient force to create a water tight seal. Leave the nut cover (9) off for now in order to check for leaks once the cistern is filled.
8. Fit cover plug (19) and washer (20) with a suitable sealant into the redundant supply feed hole in the cistern, on the internal side fit the cover plug retaining plate (26) with a little more sealant then secure in place with M6 nut (27) using enough force to create a seal.
9. Fit lever bush (34) into the cistern and from the rear install washer (21), lever return spring base (22) and secure with nut (23) using only sufficient force to secure in place. Pass the flush lever (34) through the bush then from the rear slide on the flush arm (25) and secure with grub screw (24) making sure that it is in the correct position once the chain is connected from the flush valve, which can now be connected.
10. Install float valve (31) and washer (32) with suitable sealant through the cistern base and secure with back nut (36), do not over tighten.
11. The supply pipe (37), escutcheon (17) and associated nuts and olives (15 and 16) can be fitted to the base of the float valve and water supply next taking care with any plating on the escutcheon. Whilst tightening the 1/2" nuts take care not to place any undue strain on the installation and that the float valve has not been disturbed.
12. Remove any excess sealant from the installation.
13. The seat and lid will have to be attached to the pan in order to provide a template for the seat support rubber fixing position. Attach the toilet seat to the pan temporarily with the bolts, washer and nuts provided ensuring that it is in the correct position (see drawing) and that the seat and lid are able to remain in the upright position resting upon the cistern. From under the seat draw around the pan leaving a line on the under side of the seat, do this from the internal side of the pan also. Remove the seat and screw the four support rubbers in the correct place between the pencil lines. Refit the seat and lid and check that it operates freely and sits correctly on the pan.
14. Fill the cistern adjusting the water level if necessary by means of adjustment on the float valve and check that the installation operates properly and that there are no water leaks.
15. Fit the flush pipe nut cover (9) and cistern lid (30).

Cleaning

Brass - use a mild non-abrasive cleaner such as brasso.

Chrome and nickel plated products - use a mild non-abrasive cleaner such as silvo.

Chinaware - use a proprietary non abrasive bathroom cleaner.

Notes: Drummond's products are handmade therefore dimensions may vary slightly. Please try to recycle all packaging where possible and leave the item well protected for the customer - thank you.

The manufacturer's warranty does not cover any products which have been damaged as a result of misuse, faulty installation or maintenance.

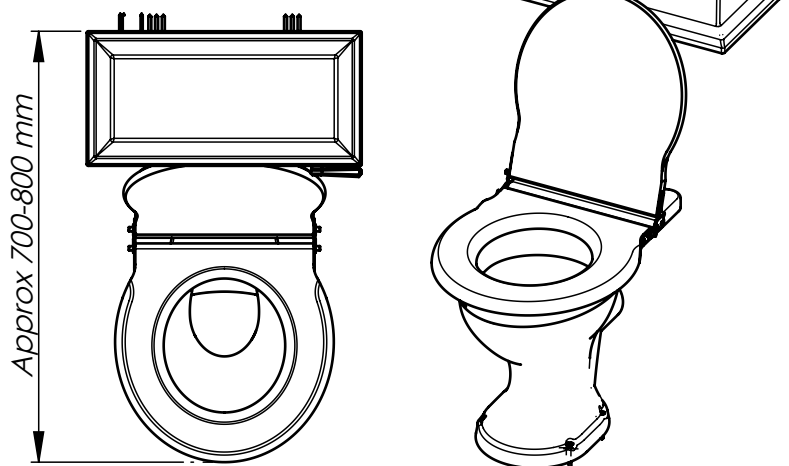

All our goods are handmade and may vary slightly from drawings. If you are unsure of how to assemble the goods, please call us and we will try help over the phone. We would also ask that you try and recycle all packing where possible and leave the item well protected for the customer. Thank you.